

12-Inch, 3-Way Studio Monitor

Model 4312EBK

Owner's Manual

The 4312EBK is a new member of the family of JBL® bookshelf studio monitor speakers that dates back to 1968 with the original model 4310 Control Monitor.

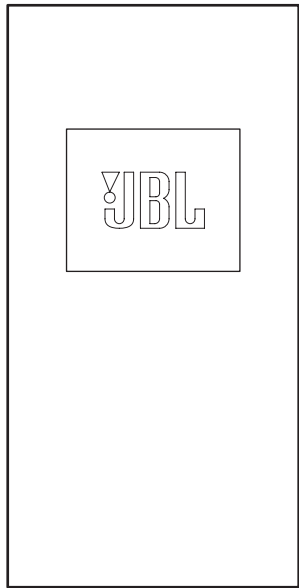
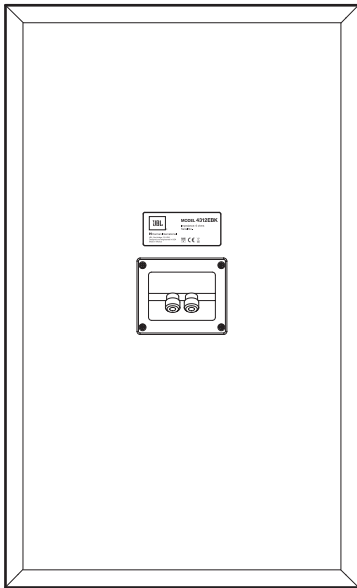
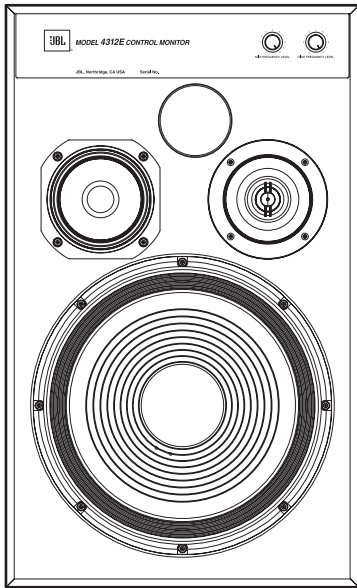

1. Introduction

Thank you for purchasing the **JBL® 4312EBK 3-Way Studio Monitor**.

For more than 60 years, JBL has been providing audio equipment for concert halls, recording studios and movie theaters around the world and has become the hands-down choice of leading recording artists and sound engineers. The 4312EBK is a new member of the family of JBL bookshelf studio monitor speakers that dates back to 1968 with the original model 4310 Control Monitor. To get the best performance from your new studio monitor, please read these instructions thoroughly.

2. Package Contents

Each JBL 4312EBK box contains one (1) JBL 4312EBK studio monitor speaker. If you suspect that there has been shipping damage, report it immediately to your dealer. We recommend that you keep the box and packing materials for future use.

3. Placement

CAUTION: The 4312EBK weighs 39.5 lb (17.9kg). Before placing the speaker on a shelf or platform, be sure that it is sturdy enough to support the speaker's weight.

Before deciding where to place your speakers, survey your room and think about placement, using the illustration below as a guide.

- Avoid placing the speakers near power amplifiers, heat registers or other objects that generate large amounts of heat.
- Do not place the speakers in very humid or dusty places.
- Do not place the speakers in direct sunlight or where they will be exposed to other strong light.
- The 4312EBK is not video-shielded, and may cause picture discoloration or distortion if placed close to some types of TVs. If this occurs, move the speakers away from the TV until the discoloration or distortion disappears.
- For best results, place the speakers 6–8 feet (1.8-2.4m) apart. If you place the speakers farther apart than this, angle them toward the listening position.
- The speakers will produce the most accurate stereo soundstage when the angle between the listener and the speakers is between 40 and 60 degrees.
- Position each speaker so that its tweeter is approximately at ear level.
- Generally, bass output will increase as the speaker is moved closer to a wall or corner. For best performance, we recommend that you place the speakers at least 20 inches (50cm) away from the side walls.

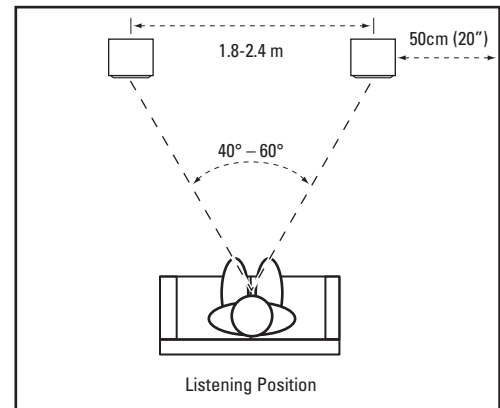

4. Connections

CAUTION: Make sure that all of the system's electrical components are turned OFF (and preferably unplugged from their AC outlets) before making any connections.

Speakers and amplifiers have corresponding positive and negative ("+" and "-") connection terminals. The 4312EBK has color-coded connection terminals. The "+" terminal is red, while the "-" terminal is black. See the illustration on the right.

The 4312EBK is designed so that a positive voltage at the "+" (red) terminal will cause the speaker drivers to move outward (toward the room).

We recommend using a high-quality speaker wire with polarity coding. The side of the wire with a ridge or other coding is usually considered positive polarity ("+").

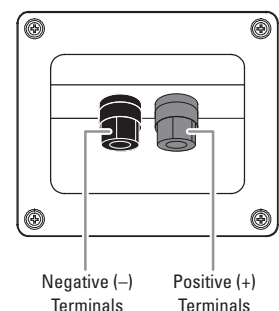

To ensure proper polarity, connect each “+” terminal on the back of the amplifier or receiver to the respective “+” (red) terminal on each speaker. Connect the “-” (black) terminals in a similar way. See your receiver or amplifier’s owner’s manual to confirm its connection procedures.

5. Basic Single-Wire Connection

Connect the amplifier to each speaker as shown in the illustration on the right. You can use either set of terminals on the speaker. **NOTE:** Do not remove the metal jumpers from between the two sets of terminals when connecting the speaker wires.

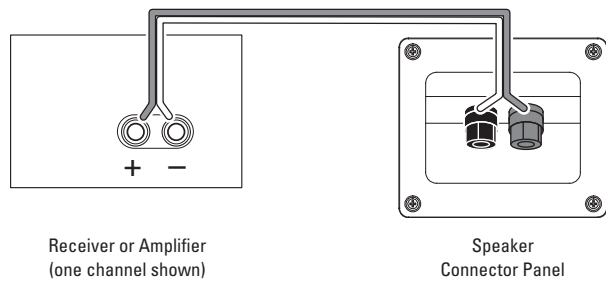

IMPORTANT: Do not reverse polarities (i.e., “+” to “-” or “-” to “+”) when making connections. Doing so will cause poor stereo imaging and diminished bass performance.

The 4312EBK’s gold-plated speaker terminals can accept a variety of wire connector types: bare wire, spade connectors, pin connectors and banana connectors.

Using Bare Wire or Pin Connectors:

IMPORTANT: Make sure that the (+) and (-) wires or pins do not touch each other or the other terminal. Touching wires can cause a short circuit that can damage your receiver or amplifier.

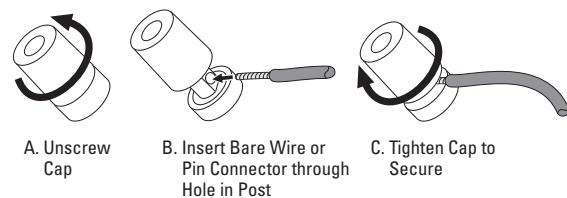

Using Spade Connectors:

IMPORTANT: Make sure the (+) and (-) spade connector blades do not touch each other or the other terminal. Touching blades can cause a short circuit that can damage your receiver or amplifier.

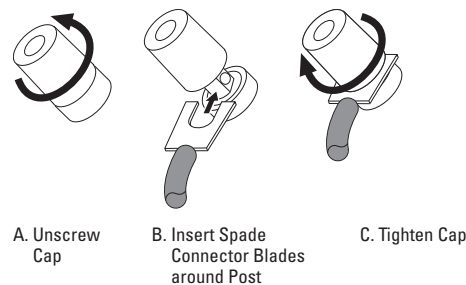

Using Banana Connectors:

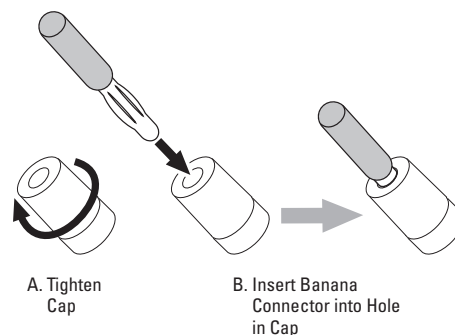

6. Controls/Adjustments

The 4312EBK has front-panel adjustments that let you balance the levels of the midrange driver (MF) and tweeter (HF) against the woofer.

You can use these controls to adjust the speaker's sound according to your room's acoustics, or your personal taste. The 0dB positions are indicated.

As with most speakers, after you start playing the 4312EBK it will take the drivers' suspensions several weeks to "break in" and achieve optimum performance. During this period, the balance between the woofer, midrange and tweeter may change, so we recommend that you adjust the midrange and tweeter controls accordingly.

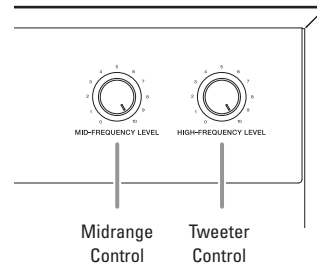

7. Caring for Your Speakers

- Wipe the cabinet with a clean, dry cloth to remove dust. Damp cloths or cleaning paper may dull the cabinet's finish.
- Do not use volatile liquids such as benzene, paint thinner, alcohol, etc., on the cabinet. Do not spray insecticide near the cabinet.
- To remove dust from the grille fabric, use a vacuum cleaner set to low suction.
- Do not wash the grille in water, as this may fade the color or make it uneven.
- If the surfaces of the woofer and midrange cones become dusty, you can carefully sweep them clean with a soft, dry calligraphy brush or paint brush. Do *not* use a damp cloth.
- NEVER touch *anything* to the tweeter dome.

8. Specifications

Speaker Type	3-Way Bookshelf
Woofer	300mm Pure Pulp Cone (Model 2213Nd-2)
Midrange	125mm Pure Pulp Cone (Model 105H-1)
Tweeter	25mm Aluminum Magnesium Alloy Dome (Model 054ALMg)
Impedance	6 ohms
Maximum Recommended Amplifier Power	200 watts RMS
Sensitivity (2.83V/1m)	93dB
Frequency response	40Hz–40kHz (-6dB, half Space)
Crossover frequencies	2kHz, 5kHz
Dimensions (W x H x D)	14-1/4" x 23-1/2" x 11-3/4" (362mm x 597mm x 299mm)
Weight	39.5 lb (17.9kg)

